



High Carbon Steel Coffee Burrs Grinder Blades Wear Level Less Expensive

Our Product Introduction

Basic Information

- Place of Origin: China
- Brand Name: Seton
- Certification: CE ISO
- Model Number: High-Carbon Steel
- Minimum Order Quantity: MOQ 10 Pieces
- Price: Can be discussed
- Packaging Details: 1pc/wrapper, 100pcs/box, 100boxes/ctn, Wooden and carbon boxes
- Delivery Time: 30 days
- Payment Terms: L/C, D/A, D/P, T/T, Western Union, MoneyGram
- Supply Ability: 500 Piece/Pieces per Day



Product Specification

- Product Name: Conical Coffee Grinder Replacement Burrs
- Material: High-Carbon Steel
- OD: 29.5mm
- Height: 20mm
- Center Hole: 7.25mm
- Hardness: HRC44-52
- Application: Grinding Coffee Beans
- Manual Or Electric: Coffee Bean Milling Burr
- Highlight: **Wear Level Coffee Grinder Replacement Burrs, Conical Coffee Grinder Replacement Burrs, High Carbon Steel coffee grinder parts**



for more products please visit us on blade-industrial.com

Product Description

High Carbon Steel Coffee Burrs Grinder Blades Wear Level Less Expensive

Description:

The best grind setting for espresso is typically a fine grind. Here are some key points to consider:

- 1. Grind Size
Fine Grind: The coffee should feel similar to granulated sugar or slightly finer. This allows for optimal extraction during the short brewing time of espresso.
- 2. Consistency
Uniformity: A consistent grind size is crucial to ensure even extraction. Inconsistent grinds can lead to over-extraction (bitter taste) or under-extraction (sour taste).
- 3. Adjustability
Burr Grinder: Use a burr grinder with adjustable settings to find the ideal fineness for your specific espresso machine and coffee beans.
- 4. Tamping Pressure
Compaction: When using a fine grind, ensure you tamp the coffee evenly and with the right pressure to create a compact puck, enhancing extraction.
- 5. Testing and Calibration
Trial and Error: It may take some experimentation to find the perfect grind size based on your beans, machine, and personal taste preferences. Start with a fine setting and adjust as needed.

Coffee Blade Specifications:

Product Name	Conical Coffee Grinder Replacement Burrs
Material	High-Carbon Steel
OD	29.5mm
Height	20mm
Center Hole	7.25mm
Hardness	HRC44-52
Application	Grinding coffee beans
Manual or electric	Coffee Bean Milling Burr

Material Characteristics of Coffee Burr Grinder Blades

- 1. Stainless Steel

Durability: Stainless steel burrs are resistant to corrosion and wear, ensuring a long lifespan.
Sharpness: They maintain sharp edges, providing efficient grinding performance.
Hygienic: Easy to clean and maintain, making them suitable for food applications.
- 2. High-Speed Steel (HSS)

Hardness: HSS burrs are exceptionally hard, allowing them to withstand high-speed grinding.
Heat Resistance: They retain their hardness at elevated temperatures, helping to preserve the flavor of the coffee.
Versatility: Suitable for various grinding applications, including coffee and spices.
- 3. Tungsten Carbide

Extreme Hardness: Tungsten carbide burrs are among the hardest materials available, providing superior wear resistance.
Longevity: They have a longer lifespan, making them ideal for high-volume grinding applications.
Precision: Offer precise grinding, producing a consistent grind size.
- 4. Ceramic

Non-Corrosive: Ceramic burrs are resistant to corrosion and do not impart any metallic taste to the ground material.
Consistency: Provide a uniform grind size but may be more brittle than metal options.
Low Heat Generation: Generate less heat during grinding, which helps preserve flavor.

Picture:



Size:

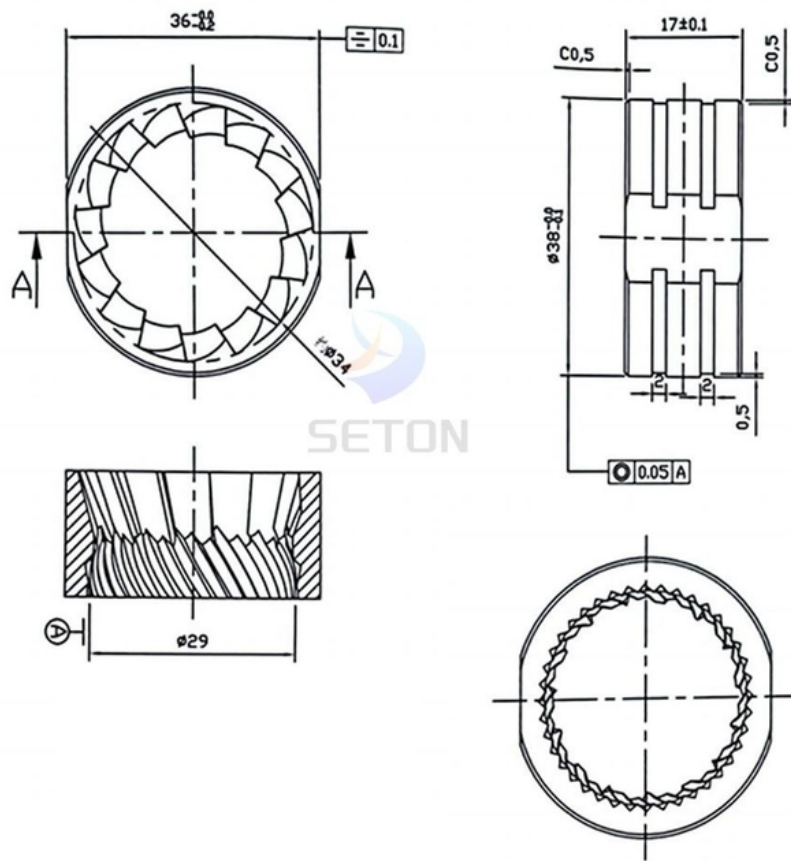

Applications:



Packing:

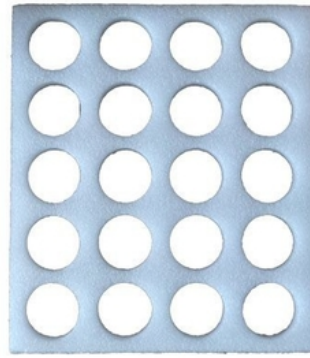

Jiangsu Seton Industrial Technology Co.,Ltd



+86 15852715407



alen@setonindustrial.com



blade-industrial.com

No.99 Furong Mid Three Road,Xishan Economic Development Zone.Wixi.